

GOTESSONS DECORATES BRAVELY WITH COLOUR

AFTER JUST FOUR YEARS IN THE NEW OFFICE IN ULRICEHAMN THAT 2015 WAS NAMED SWEDEN'S THIRD BEST LOOKING OFFICE, THE EXPANSION OF 4000 SQUARE METERS IS COMPLETED. –IT'S BEEN IMPORTANT TO CREATE A WHOLESOME FEELING IN THE BUILDING, THIS BEING THE REASON THAT I CARRIED ON WITH THE CURRENT ANIMAL AND PLANT THEME, EXPLAINS GOTESSONS' MARKETING DIRECTOR, JESSICA CARLSTEIN, WHO IS RESPONSIBLE FOR THE BOLD INTERIOR CONCEPT.

Gotessons' main sales area is furniture and accessories for offices, conferences, hotels and schools, making the head office a natural and ever-changing showroom. Together with carefully chosen furniture from other brands, trendy environments are created in every corner. In one of the new parts of the office, a cosy lounge has been built with Gotessons' own sound absorbing houses and soft seating. This is a place for colleagues to meet over a cup of coffee or have a relaxed meeting. –We have several areas inspired by the popular activity based concept where our staff can choose to work, explains Jessica Carlstein. Changing environments is a great way to increase creativity.



"IT'S BEEN IMPORTANT TO CREATE A WHOLESOME FEELING IN THE BUILDING"

An impressive patterned wallpaper with large swans covers one of the walls and is accompanied by monkeys holding lamps, suspended from the ceiling. In other parts of the office, a wallpaper with tigers and another with horses by Lisa Bengtsson tie the animal theme together. The colour theme on the second floor carries on in pastels, light grey and silver with tones of petrol blue and green. The first floor is more characterized by a deep colour scale with wine red tones, mixed with mustard yellow, black and gold with oak wood.



ACOUSTIC FOCUS FOR BETTER WORK ENVIRONMENTS

A mix between separate offices and open landscapes are a pervading theme in the building, which demands good acoustics. Thanks to Gotessons' own line of sound absorbing products, this was a natural part of the original planning.

Different kinds of carpet together with ceiling and wall sound absorbants from Gotessons' own assortment are frequently used in the office spaces to prevent noise to bounce. Some absorbents can be printed with own photographs or artistic motifs which adds a personal touch.

– In the new parts of the warehouse, a big large part of our staff stand up working by their individual stations while their colleagues drive trucks in the corridors, explains Jessica Carlstein. We have installed sound absorbents on the walls in the ceiling in order to improve the sound environment and decrease the noise levels

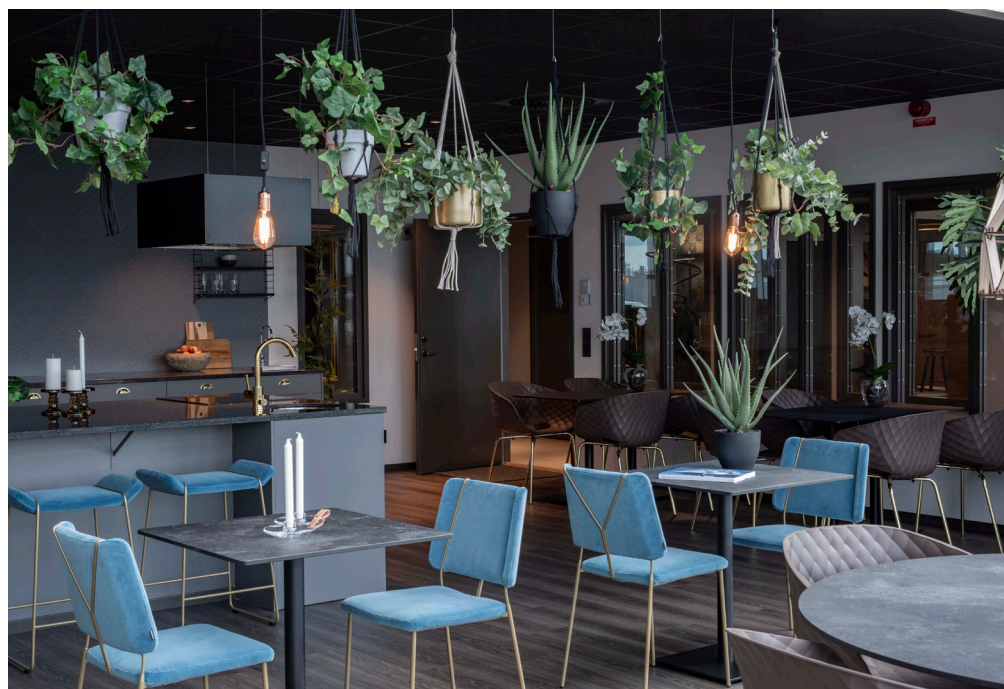

ADD A GREEN TOUCH

The kitchen can be described as the heart of Gotessons where everyone meets to eat together; the different and spread out departments can gather and socialize. –When we planned the expansion, I wanted to do something extra and approached the idea of a green house and conservatory, Jessica Carlstein says. With walls and a ceiling of glass, a lovely light is let in and the whole lunch room has been decorated with artificial plants from the own assortment. The green details turn the create a warm and welcoming environment for both food breaks and meetings. Greenery runs through all the decorative choices at Gotessons and confirms the trend that plants are the right details in every place.

